



MLB-TOOL Adapter

User's Manual



Xhorse APP



1 Supported models

This adapter is used to the data acquisition of keys for Audi, Porsche, Volkswagen, Lamborghini, Bentley and other MLB models, and can be used with VVDI2, KEYTOOL PLUS and other professional tools to make key, add key and program key. (For the types of keys supported for programming, please refer to the relevant help terms of the special software)

2 Reference procedure

2.1 Use with KEYTOOL PLUS

Step 1: First make sure the KEYTOOL PLUS is not connected to the OBD cable, then plug the MLB-TOOL adapter connected USB cable into the OTG data adapter, and plug the TYPE-C end of the OTG data adapter into the KEYTOOL PLUS TYPE-C USB port. Put the original car key in the MLB device sensing area to identify the original key.

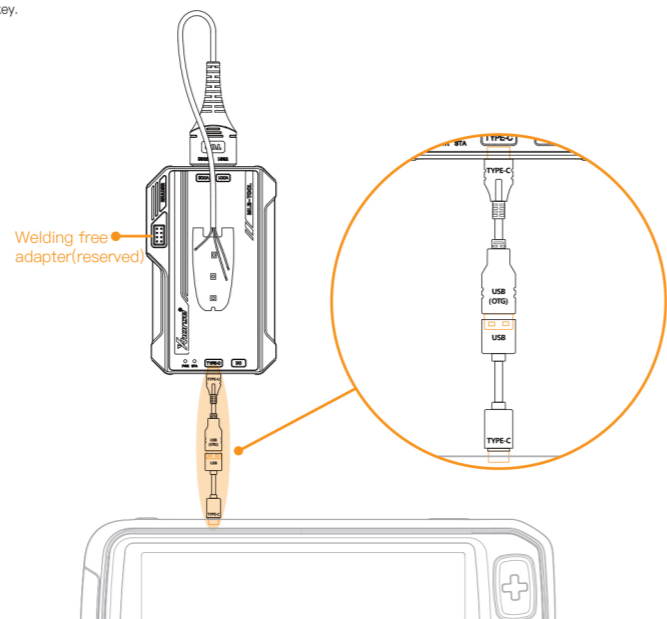

Figure 2.1.1 MLB Adapter and KEYTOOL PLUS Connection Diagram

Step 2: Please follow the software's help tips to confirm that the key is a supportable type for the device, then remove the shell of the original key, take out the original key PCB, and refer to the software's operating instructions to perform the relevant welding operation. After the welding operation is completed, plug the welding harness into the corresponding port of the MLB-TOOL adapter, and at the same time, put the key flat in the center of the device's sensing area.

Step 3: Select the [Key Data Acquisition] function in the MLB-TOOL adapter software to acquire and calculate data online.

Step 4: After the calculation data is completed, the dealer key can be generated (if you need to use the original vehicle ID, please read the vehicle information to get the ID first, and then use the [Modify Key ID] function to operate).

Step 5: Program New Key.

Please select operation option:

Read vehicle information	1-Identification key	2-Connection diagram	3-Collect key data
4-Make Dealer Key	5-Learn Key	Immo status	Modify key ID
Recover the key	Query the last calculation result of the server.	MLB Device Firmware Upgrade	Binding MLB devices

Figure 2.1.2 KEYTOOL PLUS key programming interface

2.2 Use with VVDI2

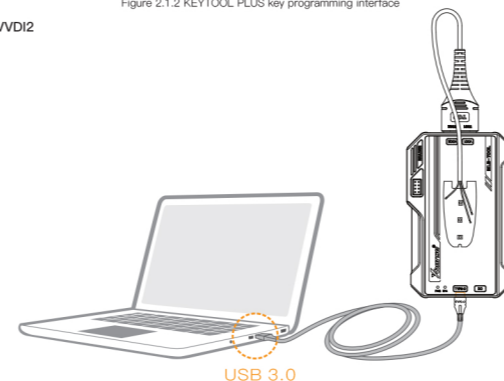

Figure 2.2.1 Diagram of MLB-TOOL adapter and PC connection

Step 1: Connect the MLB-TOOL adapter to the PC via USB cable (no need to use OTG data adapter), put the original key in the MLB device sensing area, and run the MLB software (the MLB-TOOL software can be obtained by contacting the dealership or customer service). Put the original key in the MLB device sensing area to identify the original key.

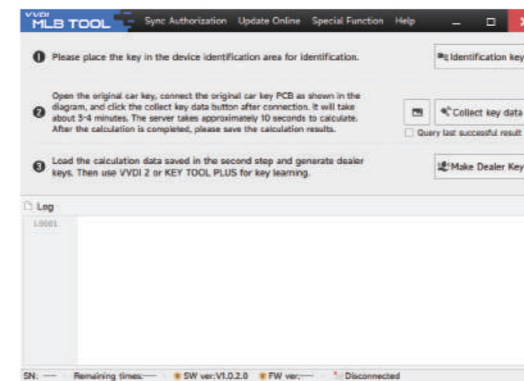

Fig.2.2.2 MLB-TOOL PC software

Step 2: Please follow the software's help tips to confirm that the key is a supportable type for the device, then remove the shell of the original key, take out the original key PCB, and refer to the software's operating instructions to perform the relevant welding operation. After the welding operation is completed, plug the welding harness into the corresponding port of the MLB-TOOL adapter, and at the same time, put the key flat in the center of the device's sensing area.

Step 3: Select the [Key Data Acquisition] function in the MLB-TOOL adapter software to acquire and calculate data online.

Step 4: Enter the MLB menu of VVDI2 software (Main Menu->Key Programming->MLB Key Programming), generate a dealer key (if you need to use the original key ID, first read the vehicle information to get the ID, and then use the [Modify Key ID function]).

Step 5: Program New Key.

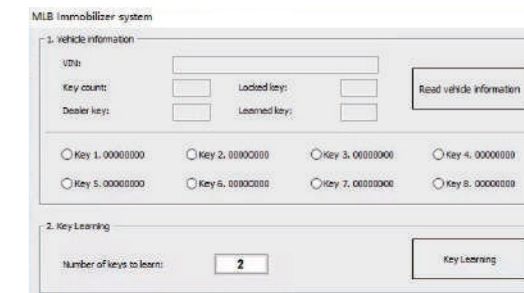

Figure 2.2.3 VVDI2 software key programming interface

3 Attention

3.1 For some models with SFD diagnostic protection after 2024, it is necessary to make the dealer key with original key ID and then use the ODIS software to program remotely by a third party.

3.2 The device needs to be regularly synchronized with the network, the default number of uses is 1000, when the remaining number of times is insufficient, the system will be reminded, at this time you need to synchronize with the network authorization, the number of uses will be restored to the default after the success of synchronization.

4 Warranty

The VVDI MLB TOOL warranty period is one year, based on the date on the transaction voucher; if there is no transaction voucher or if the transaction voucher is lost, the factory date recorded by the manufacturer shall prevail.

* The warranty is not free of charge in the following cases:

- The machine malfunctions as a result of not using the machine according to the instructions;
- Damage to the machine caused by self-repair or modification;
- Machine failure due to drop, collision or improper voltage;
- If the machine is damaged due to force majeure;
- If the machine malfunctions or is damaged due to prolonged use in bad conditions or on vehicles or ships;
- The main unit housing is dirty and worn out due to use.

For product after-sales maintenance and technical support, please contact your dealer or scan the QR code on the back of the manual, download the Xhorse official APP and consult online customer service.

Images are for reference only, products are subject to physical condition. Xhorse reserves all rights to this manual. Reproduction and distribution of any part of this manual in any form by any person or organization without permission is prohibited. The contents of this manual are subject to change without notice due to product improvements.